

# TEKNO 450

Two-bowl sink

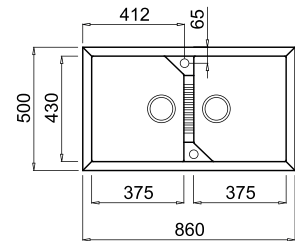

## FEATURES

Dimensions (mm) **860 x 500**  
 Built-in (mm) **840 x 480**



## AVAILABLE MATERIALS AND COLOURS

### METALTEK<sup>®</sup> GRANITE METALLIC EFFECT

	M79 Aluminium	<b>LMT45079</b>
	M78 Espresso	<b>LMT45078</b>
	M73 Titanium	<b>LMT45073</b>
	M70 Ghisa	<b>LMT45070</b>

### GRANITEK<sup>®</sup> NATURAL GRANITE EFFECT

	G68 Bianco	<b>LGT45068</b>
	G62 Bianco Antico	<b>LGT45062</b>
	G59 Antracite	<b>LGT45059</b>
	G48 Cemento	<b>LGT45048</b>
	G43 Tortora	<b>LGT45043</b>

G40 Nero **LGT45040**

# TEKNO 400

One-bowl sink with drainage area

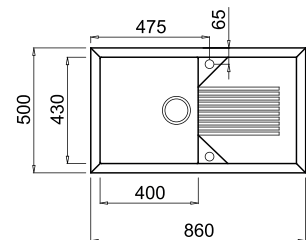

## FEATURES

Dimensions (mm) **860 x 500**  
 Built-in (mm) **840 x 480**



## AVAILABLE MATERIALS AND COLOURS

### METALTEK<sup>®</sup> GRANITE METALLIC EFFECT

	M79 Aluminium	<b>LMT40079</b>
	M78 Espresso	<b>LMT40078</b>
	M73 Titanium	<b>LMT40073</b>
	M70 Ghisa	<b>LMT40070</b>

### GRANITEK<sup>®</sup> NATURAL GRANITE EFFECT

	G68 Bianco	<b>LGT40068</b>
	G62 Bianco Antico	<b>LGT40062</b>
	G59 Antracite	<b>LGT40059</b>
	G48 Cemento	<b>LGT40048</b>
	G43 Tortora	<b>LGT40043</b>

G40 Nero **LGT40040**

## ELEMENT



50 cm sliding element  
 Multifunctional chopping  
 board of HPL  
 Code  
**ATH010\_**  
 Page 157



Pop-Up Element  
 2-way and 1-way Push-  
 Control  
 Code  
 2-way **ASP23002**  
 1-way **ASP13002**  
 Page 161

## CHOPPING BOARD



Sliding glass chopping  
 board  
 Code  
**ATV01000**