

# Installation Manual

## SIBER® DRY BALL TRAP



Ventilación inteligente

### BALL TRAP FOR THE SIBER DF EVO UNITS

- ✓ Allows the drainage of the condensates from the ventilation unit and prevents the entry of unpleasant odours into the ventilation system thanks to its non-return ball mechanism.



### DIMENSIONS

- Measurements in millimetres (mm)

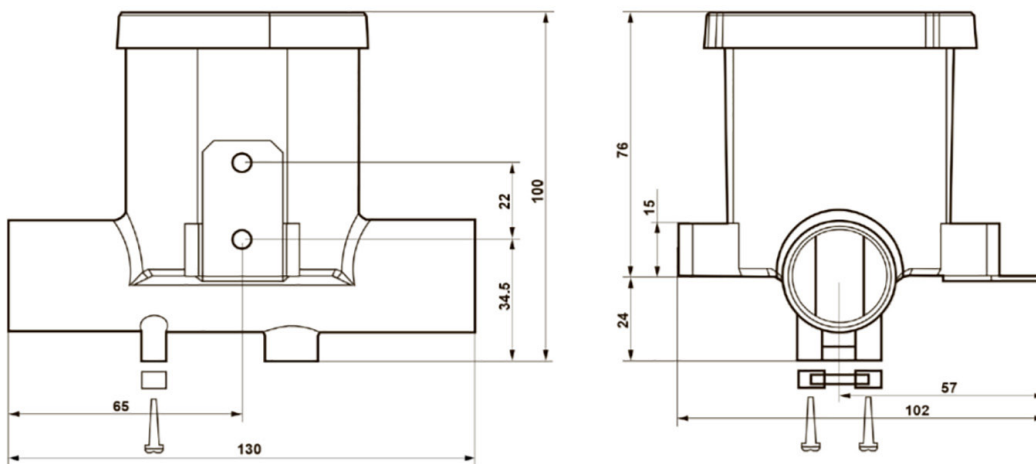

### INSTALLATION

- The connection fitting for the condensate drain with  $\frac{3}{4}$ " male thread must be screwed into the unit's condensate tank by the installer.
- The condensate drain pipe can be fitted underneath. The installer can adjust the condensate drain into the desired position. The drain must end at the trap water level.
- Use a 32 mm diameter condensate drain pipe.



**Important!** Always use a detachable fitting for the condensate drain between the trap and the unit for ease of maintenance.



**Take special care in the case of ceiling mounting that the trap is located below the level of the SIBER DF EVO 1/2.**

## Installation example

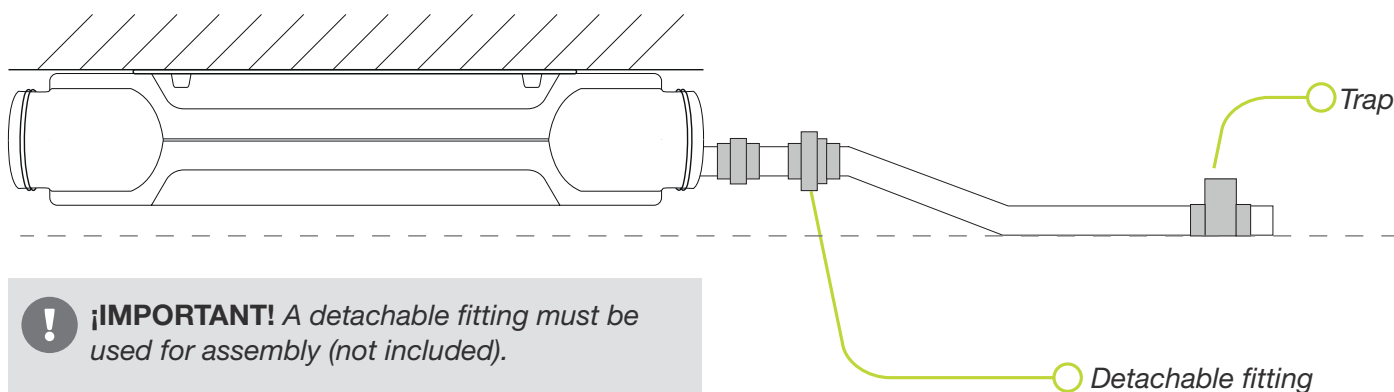

**! ¡IMPORTANT!** A detachable fitting must be used for assembly (not included).

**! ¡IMPORTANT!** The trap must be installed at a lower level than the device drain.

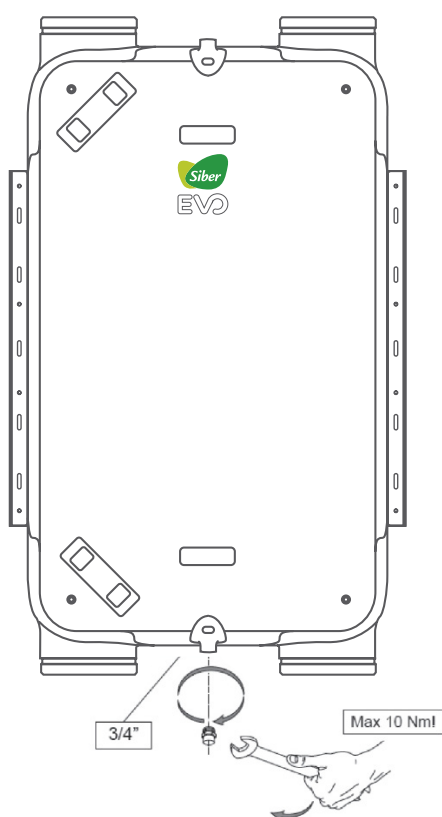

### Accessory position

Condensate drain pipe connection

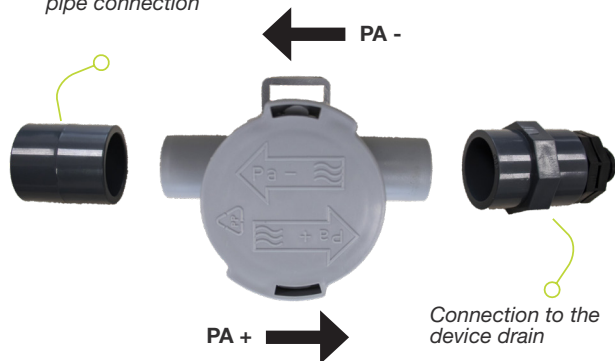

Connection to the device drain

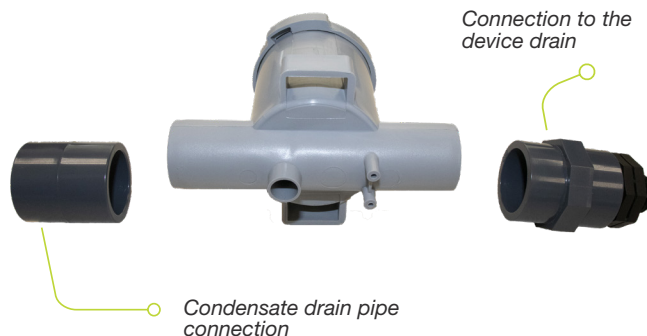

### **! Note:**

**In the case of ceiling installation:** install the condensate trap in the drain on the side of the pipes that are connected to the outside. The other drain must be capped with the plug.

**In the case of wall installation:** install the condensate trap in the bottom drain of the device. The other drain must be capped with the plug.

### **! Note:**

**In the case of heat recovery models,** both drains must be closed with plugs as the trap is not necessary.